

IAQ Map Legend - Winter Operation

Natural ventilation: Operable windows and/or louvres should be used to manage fresh air, balancing thermal comfort and ventilation.

Mechanical ventilation: Fresh air is introduced by the heating, ventilation and air conditioning system when in operation. Windows can remain closed and no action is required by the school.

Note: White spaces are to be used in accordance with COVID-19 requirements and current health advice.

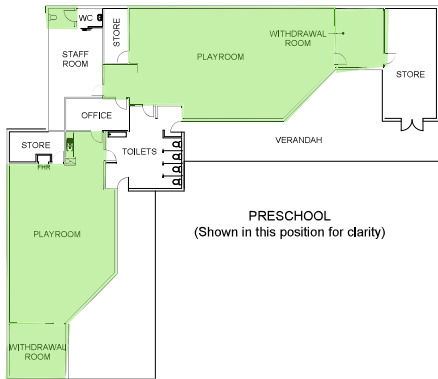
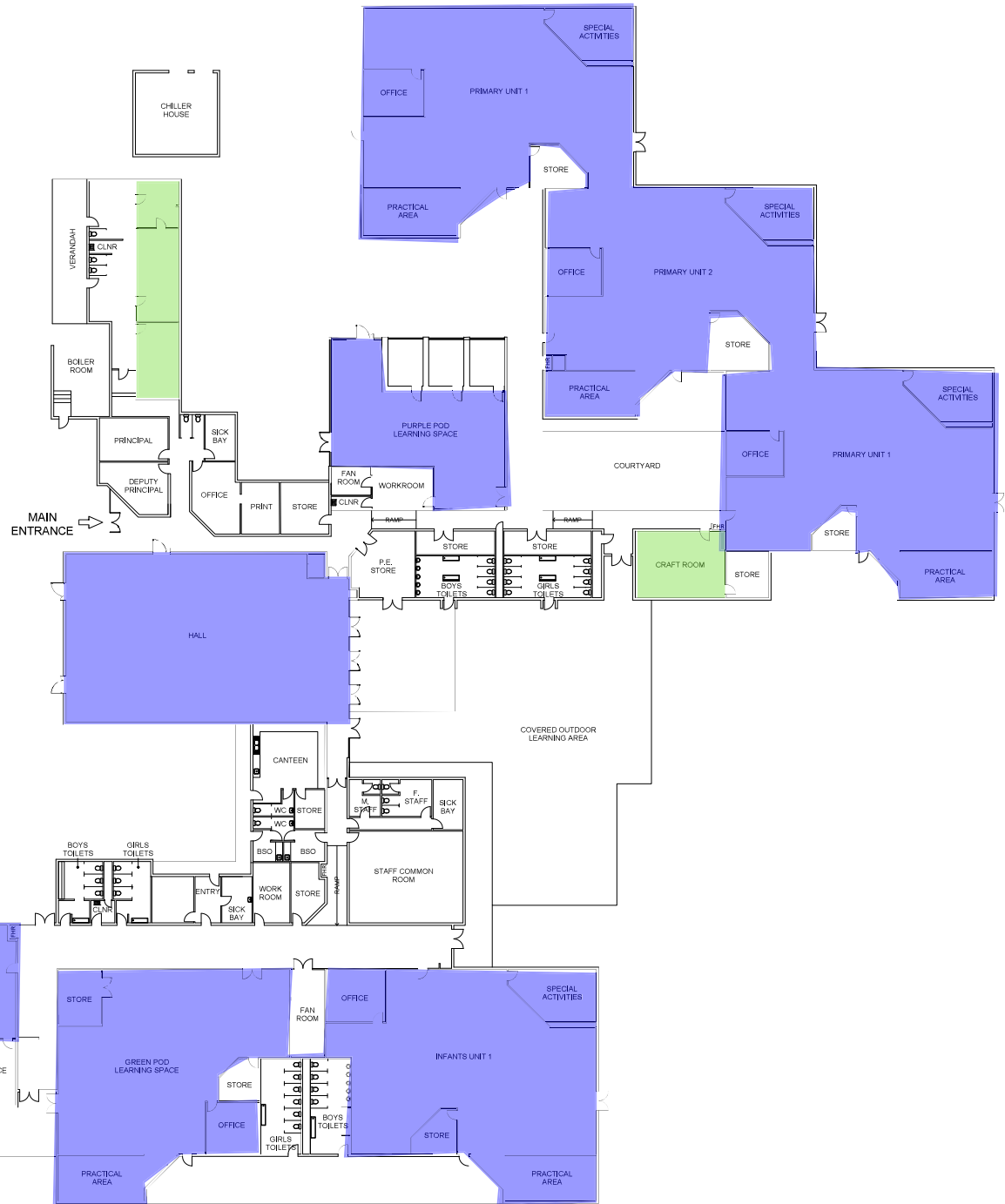

ISSUE	AMENDMENT	DRAWN	VER'D	APP'D	DATE

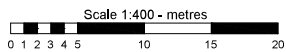

SCALE
1:400
DATE
JANUARY 2018
DRAWING SHEET SIZE = A3



PROJECT
WANNIASSA JUNIOR SCHOOL
INFRASTRUCTURE & CAPITAL WORKS
SCHOOL LAYOUT PLAN